

Q32 Data Sheet

Manufacturer: Cerámica La Escandella S.A.
Production site: Agost (Alicante) - Spain
Brand name: 4-Eave blanket **Q32**

Dimensions* **A** 470 mm / 18,5 "

Pieces per ml 4
Weight per unidad 2,5 kg / 5,5 lbs
Units per pallet 120

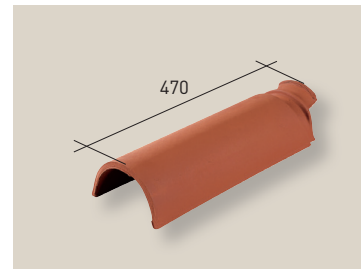

*The tile dimensions indicated in this chart allow a tolerance of approximately +/-2%

Structural characteristics:	UNE EN 1304	≤ 2,5
Impermeability (cm ³ / cm ² *day):	UNE EN 539-1	Mean value ≤ 0,5 ; Individual value ≤ 0,6
Froast resistance:	UNE EN 539-2	≥ 150
Fire reaction performance:	UNE EN 13501-1	A1
External fire performance:	UNE EN 13501-5	B _{roof}

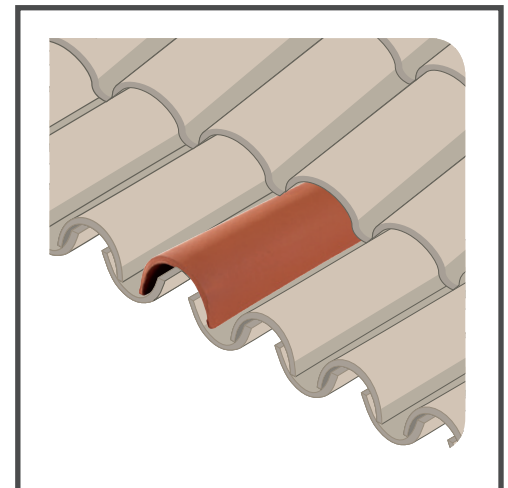

Additional information

Superficial finishes: Surface decoration with colored slips
Note: Not suitable for current TP
Pre-hole: To avoid breakage of special parts is necessary to drill necessary to drill the pre-hole with a screw punch (ø max. 4mm), before nailing or drill the piece directly.



Resistencia a la helada



Impermeabilidad



Resistencia a la flexión



Características geométricas



Conforme a la norma europea

