

Q81 Data Sheet

Manufacturer: Cerámica La Escandella S.A.
Production site: Agost (Alicante) - Spain
Brand name: Eave channel equal slope **Q81**

Dimensions*
A 454 mm / 17.9 "
B_{max} 195 mm / 7.7 "
B_{min} 133 mm / 5.2 "

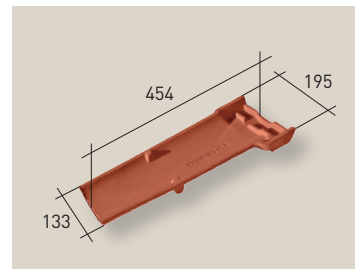

Pieces per ml 4
Weight per unidad 1,9 kg / 4.2 lbs
Units per pallet 150

*The tile dimensions indicated in this chart allow a tolerance of approximately +/-2%

Structural characteristics:	UNE EN 1304	≤ 2,5
Impermeability (cm ³ / cm ² *day):	UNE EN 539-1	Mean value ≤ 0,5 ; Individual value ≤ 0,6
Froast resistance:	UNE EN 539-2	≥ 150
Fire reaction performance:	UNE EN 13501-1	A1
External fire performance:	UNE EN 13501-5	B _{roof}

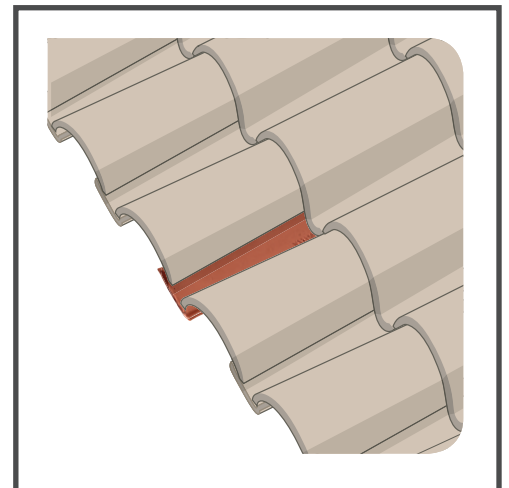

Additional information

Superficial finishes: Surface decoration with colored slips
Pre-hole: To avoid breakage of special parts is necessary to drill necessary to drill the pre-hole with a screw punch (ø max. 4mm), before nailing or drill the piece directly.



Resistencia a la helada



Impermeabilidad



Resistencia a la flexión



Características geométricas



Conforme a la norma europea

